

Kitchen

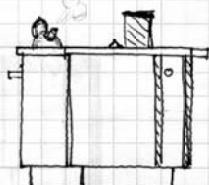

This kitchen is literally and figuratively the centre of the house as well as the first thing seen when coming through the front door. With no walls to back onto the cabinets had to work like free standing furniture - attractive from every angle. I worked extensively with the clients to develop their ideas and requirements into the built result.

Materials: Casework - Melamine, stained ash ply; Facings - cherry ply, cherry veneer, stained ash veneer and solid wood.

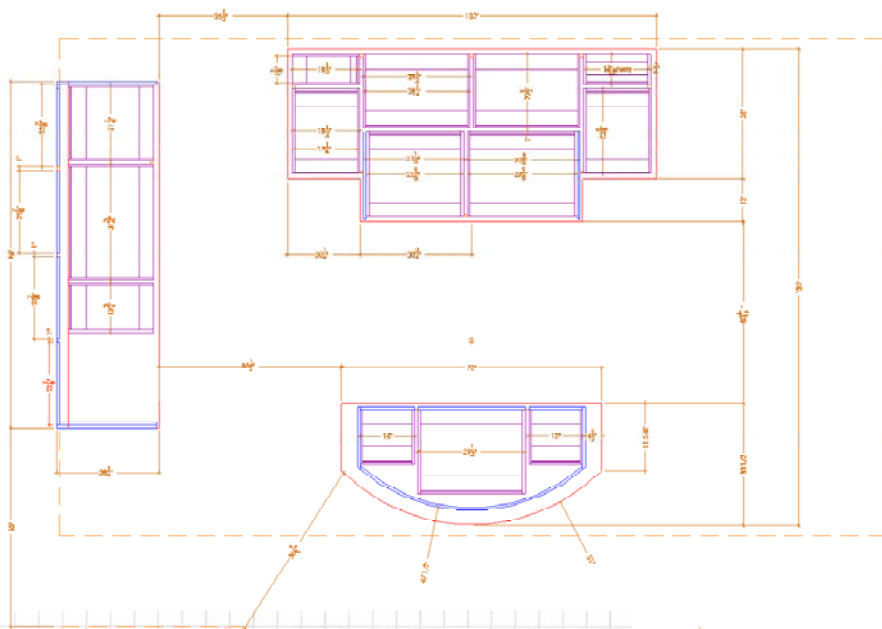

RIGHT SIDE



DINING SIDE

